

BERKSHIRE CLASS A FAMILY LINE UP



BERKSHIRE

A new adventure is awaiting you around every corner. Sophisticated décor, real hardwoods and unsurpassed attention-to-detail are all traits of a Berkshire Motorhome.



BERKSHIRE XL

Offering modern, yet easy living interiors with fresh, tasteful decors, the Berkshire XL will exceed your expectations for luxury and comfort in a Class A motorhome.



BERKSHIRE XLT

The Berkshire XLT Class A Motorhome provides a level of luxury and performance expected of a tag axle with an unmatched value driven price point.



CHARLESTON

A Charleston Motorhome brings unparalleled design and performance together with a contemporary interior. It features a quality Freightliner XCR raised rail chassis.

YOUR BERKSHIRE DEALER:

Berkshire

FOLLOW US:



CONTACT INFORMATION: Forest River Diesel Division

1800 W. Hively Ave., Elkhart, IN 46517

(574) 522-3693

www.foresriverinc.com

www.shopforestriver.com

All information contained in this brochure is believed to be accurate at the time of publication. However, during the model year, it may be necessary to make revisions and Forest River, Inc., reserves the right to make all such changes without notice, including prices, colors, materials, equipment and specifications as well as the addition of new models and the discontinuance of models shown in this brochure. Therefore, please consult with your Forest River dealer and confirm the existence of any materials, design or specifications that are material to your purchase decision.



PRE-DELIVERY INSPECTION FACILITY
20,000 square feet of quality assurance. The bare essentials for a premium product. This state-of-the-art facility gives immediate daily feedback to production for quality assurance in every unit built.

**24/7 EMERGENCY
ROADSIDE ASSISTANCE
WITH VEHICLE PURCHASE***

TOWING	WINCH-OUT
JUMP-STARTS	MOBILE MECHANIC
TIRE CHANGES	TECHNICAL
FLUID DELIVERY	SUPPORT
LOCKOUT	DEALER LOCATOR
SERVICE	SERVICES

SAFERIDERY
MOTOR CLUB

*VALID FOR 1 YEAR FROM DATE OF PURCHASE

CUSTOMER SATISFACTION

FOREST RIVER
encourages you to

BUY LOCAL

PREFERENTIAL SERVICE

PRODUCT INFORMATION

www.ForestRiverBuyLocal.com

FREE MEMBERSHIP
to Forest River Owners' Group

www.foresriverfrog.com

©Berkshire - a division of Forest River Inc.
A Berkshire Hathaway company



Learn More
Scan this barcode using a QR Reader on your smart phone to learn more about Forest River.



A Berkshire Hathaway company.

Berkshire

Berkshire

GET YOUR HANDS ON IT



Berkshire

LUXURY CLASS A DIESEL

WHEREVER YOU MAY ROAM
MAKE BERKSHIRE YOUR HOME

Berkshire



TRU-BRACE FOUNDATION



CUMMINS ISB TURBO DIESEL
6.7 LITER 360 HP, 800 FT/LBS
OF TORQUE



ALLISON 3000MH
6-SPEED TRANSMISSION



TRAILER HITCH WITH
10,000 LBS. CAPACITY



100 GALLON, LOCKING,
DUAL FILL FUEL TANK



DRIVERS SIDE
MOUNTED 13 GALLON DEF



Driven By You

IT'S ALL ABOUT THE DRIVING FORCE

ANTI-CAMBER SUPPORT BRACING found on our TRU-BRACE FOUNDATION features an industry best 10,000 lb towing capacity. Freightliner's ZF Independent Front Suspension provides an automotive-like feel and maneuverability.



Freightliner's V-Ride™ Rear RV Suspension System, rated up to 24,000 pounds, gives you the freedom to choose more amenities and carry more cargo. It also provides superior roll stability, a smoother ride and more stable handling—in any driving condition.

Large volumetric air springs and premium Sachs Shocks deliver the smoothest ride available for your Berkshire motorhome.

The V-connection dissipates suspension forces, reducing stress on the coach for greater durability and longevity.

LIKE A PENTHOUSE SUITE ON WHEELS

Berkshire



Berkshire is a Class A motorhome brand of Forest River. It is driven by an unending pursuit for precision and quality inside and out. Offering modern interiors with fresh, livable decors, the Berkshire will exceed your expectations for luxury and comfort. 40F floorplan shown here.

The 34B floorplan is shown below, with polished porcelain tile throughout. The semi-gloss hardwood cabinetry features raised-panel doors.

Bedroom features a 72x80 motorized tilt Serta King bed, bedspread and decorative pillows. You'll also enjoy roller day/night shades and plenty of storage.



This 40F floorplan shown above is an example of just how much livable space you'll find in our spacious room designs.

The 40F bunkhouse floorplan, also shown above, offers plenty of sleeping and storage space for all the family members.

This 34B floorplan and sofa above are shown in Dusk color. Dawn and Glitz Leatherette decor colors available.

THE RIGHT PLAN FOR YOU



34B

The Berkshire 34B floorplan is shorter than the others in length. The floorplan still features all the amenities of a larger unit, but in a more compact size. A full wall slide gives the 34B a spacious hallway/bedroom with the tilt a view bed as well. It's under 36ft.

360HP WITH ALLISON 3000MH TRANSMISSION	
GVWR (lbs)	38,320
GCWR (lbs)	42,400
GAWR, Front Axle (lbs)	12,400
GAWR, Rear Axle (lbs)	20,000
Black tank (gal)	42
Fresh Water Capacity w/quick drain valve (gal)	103
Grey Tank (gal)	66
LP Tank (lbs)	82
Patio Awning Length	18'
Wheel Base	206"
Overall Width	100"
Furnace Output (BTU)	35,000
*Approx. Overall Length W/out Hitch	35' 5"
*Approx. Overall Height	12' 8"
*Approx. Overall Compartment Storage (SF)	130
Tankless continuous hot water	S



39A

Our 39A floorplan is a traditional bath and 1/2 with a spacious livingroom/dining room area featuring opposing seating. You'll find plenty of countertop space along with a large rear shower.

360HP WITH ALLISON 3000MH TRANSMISSION	
GVWR (lbs)	33,400
GCWR (lbs)	43,400
GAWR, Front Axle (lbs)	12,400
GAWR, Rear Axle (lbs)	21,000
Black tank (gal)	42
Fresh Water Capacity w/quick drain valve (gal)	103
Grey Tank (gal)	66
LP Tank (lbs)	82
Patio Awning Length	18'
Wheel Base	252"
Overall Width	100"
Furnace Output (BTU)	55,000
*Approx. Overall Length W/out Hitch	39' 8"
*Approx. Overall Height	12' 8"
*Approx. Overall Compartment Storage (SF)	183
Tankless continuous hot water	S

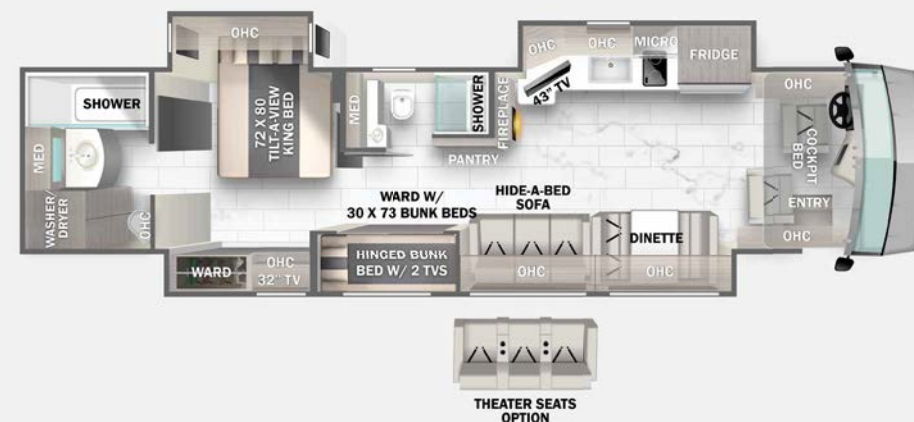

40F

This Berkshire 40F floorplan provides ample kitchen counter space, a large sofa, two full bathrooms and bunks or oversized wardrobes. It also features large, spacious showers.

360HP WITH ALLISON 3000MH TRANSMISSION	
GVWR (lbs)	37,320
GCWR (lbs)	47,320
GAWR, Front Axle (lbs)	14,320
GAWR, Rear Axle (lbs)	23,000
Black tank (gal)	42
Fresh Water Capacity w/quick drain valve (gal)	103
Grey Tank (gal)	66
LP Tank (lbs)	82
Patio Awning Length	18'
Wheel Base	266"
Overall Width	100"
Furnace Output (BTU)	40,000
*Approx. Overall Length W/out Hitch	41'
*Approx. Overall Height	12' 8"
*Approx. Overall Compartment Storage (SF)	220
Tankless continuous hot water	S

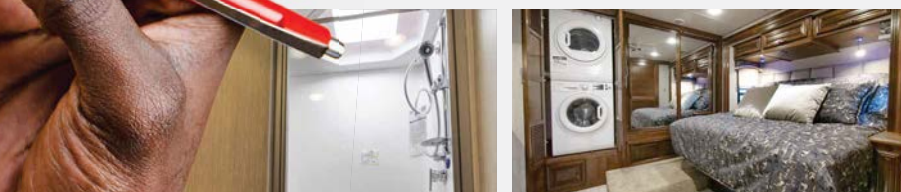

CUSTOMIZE YOUR INTERIOR

ROBUST CHERRY WOOD GRAIN



LEATHERETTE OPTIONS

- A. Dawn
- B. Dusk

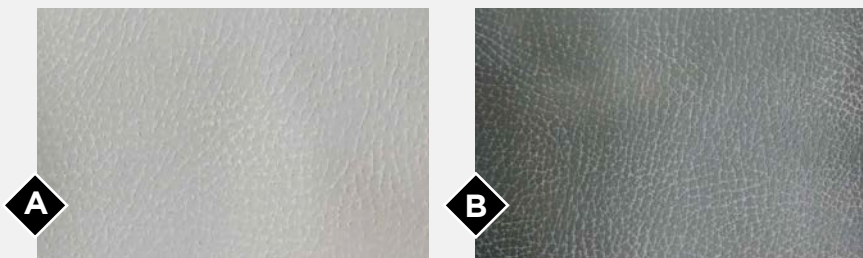

DESIGNER FABRIC OPTIONS

- A. Lumis
- B. Twilight



SURFACE OPTIONS

- A. Standard Polished Porcelain Flooring
- B. Matte Porcelain Flooring Option
- C. Standard Countertop



FIXED INTERIOR | WHITE DIAMOND GLITZ

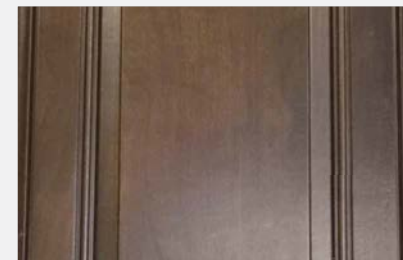

Executive Dark Cherry Wood Grain



Mist Leatherette

DESIGNER FABRICS



Standard Polished Porcelain Flooring

White Diamond Countertop

Matte Porcelain Flooring Option

PREMIUM PAINT PACKAGES

You will be the talk of the town with any of our exterior full body paint schemes. Enhanced with BASF 4x Clearcoat, it's not just made to look good, it's also made to last.

Choose from 5 different beautiful options.

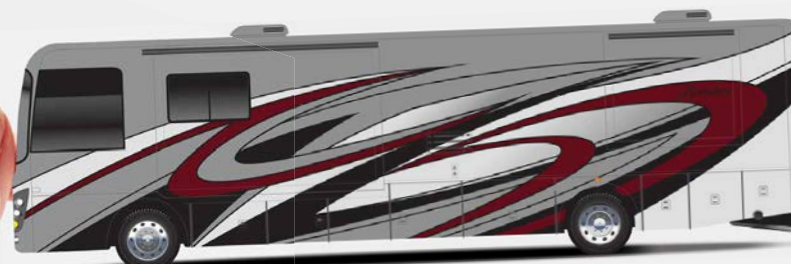

Grand Falls

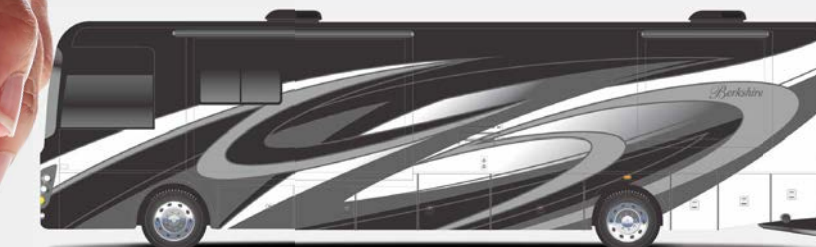

Nightfall

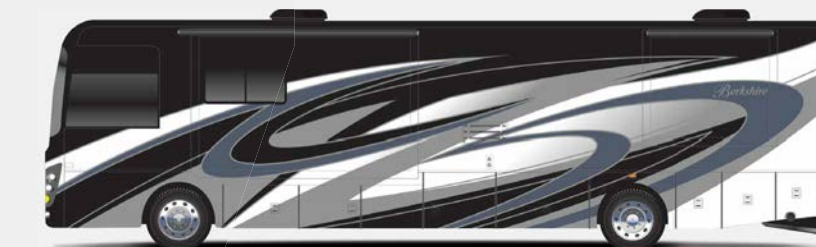

Ocean Wave



Shown in Shoreline



Shoreline

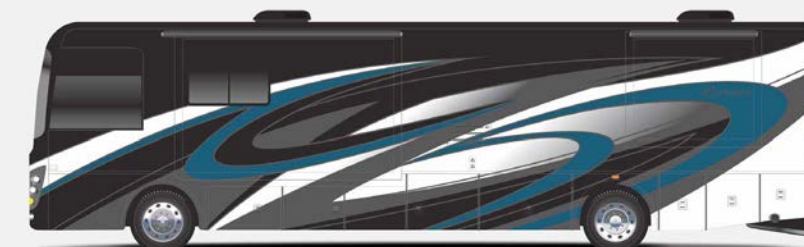

Twilight



STANDARDS

CHASSIS

- + Freightliner XCR Raised Rail Chassis
- + Cummins ISB turbo diesel 6.7 liter 360 HP, 2600 RPM, 800 LB/FT @1800 RPM
- + Allison 3000MH 6-speed transmission
- + 120v Engine Heater 750W
- + 22.5" Polished Aluminum Wheels
- + Michelin 275/80R22.5 tires
- + Trailer Hitch, 10,000 # Capacity
- + 100 gallon, locking dual fill fuel tank
- + Driver side mounted 13 Gallon DEF Tank
- + Day time running lights
- + 7-Pin tow power connector
- + 18.7 CFM air compressor
- + Farr Eco-air cleaner
- + Air filter restriction indicator
- + Fuel/water separator
- + Brake line Air Dryer w/Heater
- + Automatic, heated moisture ejectors
- + Heavy duty-windshield wipers w/intermittent function
- + 160 amp alternator
- + Full air ABS brakes w/ auto slack adjuster
- + Two (2) 1900 CCA at 0°F, maint. free
- + Variable exhaust brake
- + Suspension Neway front and V- Ride rear
- + Sachs custom tuned shock absorbers
- + 55 degree wheel cut
- + Auto air suspension deflation system
- + Rear mounted radiator
- + Transmission oil cooler
- + 5 year / 100,000 mile coolant (some maintenance required)
- + Suspended Pedals
- + Electronic cruise control w/ high idle

CONSTRUCTION AND EXTERIOR

- + Fiberglass front and rear caps
- + Full body painted exterior
- + Four (4) point fully auto hydraulic leveling system w/ auto air dump
- + Steel basement structure
- + Tru-Brace Anti Camber chassis support system
- + Rust resistant aluminized steel chassis skirts
- + Diamond shield front mask protective film
- + 1 Piece Fiberglass Molded Roof
- + Top-mount remote mirrors w/heat, & sideview cameras
- + Frameless dual pane, dark tint windows
- + Automotive foam and Ziebart seal undercoating
- + Carefree power door awning
- + Carefree Latitude dual pitch patio awning w/led lights & Wind Sensor
- + Carefree s/o topper w/covers
- + Full height strut assisted compt doors w/full pass through storage
- + "One Key" system, ext-compartment, entry door & fuel fill doors
- + Quiet integrated A/C intake/ducting roof system
- + Molded and layered vacuum bonded fiberglass roof
- + Vacuum bonded 3-1/8" Main floor w/ tubular aluminum frame
- + Vacuum bonded gel coated fiberglass with composite backing Sidewalls
- + Vacuum bonded s/o floor w/fiberglass bottom
- + Block foam polystyrene insulation in walls, roof and floors
- + 30" Entryway
- + Channeled drains for A/Cs
- + Tube steel firewall w/polystyrene insulation
- + Lighted exterior assist handle

- + 84" interior ceiling height
- + PTL steel entrance door with deadbolt & Keyless entry
- + Auxiliary air chuck (front driverside compartment)
- + Auxiliary LP supply, quick connect (passenger side)
- + LED Marker Lights
- + Full length mud flap w/ chrome Berkshire name
- + Slide tray in basement compartment

ELECTRICAL

- + All 50A service w/auto transfer switch & 30' power cord
- + EZ power cord entry
- + 8kW Onan diesel generator w/manual slide tray (N/A 40F)
- + 10kW Onan diesel generator w/manual slide tray (N/A 34B & 39A)
- + Energy management system
- + Electronic house power disconnect switch
- + Generator start/stop switch (On dash/bedroom)
- + Multi-plex w/Precision plex app control
- + Dimmer control lighting throughout
- + LED lighting package
- + Decorative bath, dinette & wall lights w/ applicable
- + Individual bed led reading lights in overhead
- + 2000kW pure sine wave inverter/charger
- + Auto generator start control
- + (6) Six volt deep cycle house batteries
- + House Battery Distribution Center (HBC)
- + Chassis & house battery bank master shut off switches
- + Led porch & patio lights
- + Easy read 12v house/Chassis load centers

- + Solar prep w/mppt controller and roof prep
- + Automotive chassis fuse panel (front driverside compt)
- + Ceiling fan in bedroom
- + 100w Solar Panel w/mppt controller

PLUMBING

- + Variable speed 4GPM water pump
- + Individual zoned hot/cold manifold water supply system
- + 4-way water management valve in water bay compartment
- + Bath - Solid surface under mount sink
- + Kitchen - Stainless steel under mount sink
- + One piece fiberglass shower w/tempered glass door & skylight
- + Whole house water filter
- + Black water tank flush system
- + Kitchen single lever faucet w/ pull-out sprayer
- + Porcelain china bowl toilet w/foot flush
- + Shurflo macerator toilet (rear bath) (N/A 34B)
- + Clean-easy exterior shower hose
- + Convenience monitor panel in water bay door
- + Gallons Tank Monitoring
- + 360 Roof vent caps

DRIVER/PASSENGER COCKPIT

- + One piece windshield
- + Power front day/night shades
- + Passenger & driver window night shades
- + 3D Carbon fiber dash panels
- + Optiview glass instrument panel
- + Steering wheel - w/radio audio, wipers, engine brake, cruise & transmission mode ctrl
- + Auxiliary Fog lights

- + 10" Dash radio w/ color back-up and side view camera pkg w/Nav.
- + JBL Dash speakers tuned amplifier system
- + Sirius/XM satellite Ready Radio
- + Leatherette driver seat, swivel & recline w/6-way power adjustments
- + Leatherette passenger seat, swivel, recline & manual footrest
- + Driver/Passenger side consoles w/cup-holders
- + Passenger seat workstation
- + Driver console wireless cellphone charger
- + Lighted step well
- + Two (2) Defroster fans w/ high and low settings
- + Automotive dash AC/heater w/deluxe controls
- + Multiple auxiliary/USB & 12V charging ports at dash
- + Power flushfloor stepwell cover
- + Multiple entry assist handles
- + Driver & Passenger LED ceiling map lights
- + Emergency/aux engine start switch at dash
- + Fitted Cockpit floormat w/"Berkshire" logo
- + Fitted entryway step carpet mats

ENTERTAINMENT

- + 49" LED TV, living room
- + 43" LED TV, living room
- + 32" LED TV, bedroom
- + 32" LED TV, exterior TV w/bluetooth radio & Speakers
- + 32" LED TV in cockpit overhead
- + 22" LED TV, (2)each bunk w/ easy access HDMI jack (40F)
- + JBL Soundbar w/integrated sub & bluetooth
- + Roof mount Winegard Trav'ler satellite prep

- + Park/cable prep
- + Auto WiFi extended range antennae & router
- + High Definition Cat6 matrix signal distribution
- + Hi-Definition digital TV antennae
- + Blu-ray DVD Player

INTERIOR

- + Polished porcelain tile throughout
- + Semi gloss hardwood cabinetry w/ glazing, interior doors & slideout fascia (Glazing N/A with executive dark cherry option)
- + Hardwood raised panel cabinet doors w/ glazing (N/A w/Executive Dark Cherry)
- + Front bed lift in cockpit
- + Hidden hinges and bar pull style cabinet hardware
- + Living room ceiling crown Trim
- + Carpeted slide-outs w/applicable
- + Decorative Window valances
- + Hardwood valance legs w/applicable
- + "Soft Touch" Dream booth dinette w/ storage underneath
- + jack knife sofa (N/A 34B & 39A)
- + Visionary Hide A Bed sofa (N/A 40F)
- + Love seat sofa (N/A 34B & 40F)
- + Polished solid surface countertops & backsplash (Kit/backsplash includes mosaic tile)
- + Full extension ball bearing metal drawer guides
- + Galley storage compartment for range and sink covers
- + Kitchen Pantry
- + Pull out kitchen drawer base (N/A 34B & 40F)
- + "Soft Touch" padded ceiling
- + Roller style day/night shades
- + Dresser drawers and wardrobe bedroom cabinetry

- + 72"x 80" Motorized Tilt Serta king bed w/bedspread & decorative pillows
- + Overhead cabinets in slide rooms
- + Bed night stands, w/dual USB jack & overhead cabinetry
- + Mirrored vanity overhead cabinet doors
- + Towel bar, toilet paper holder & towel ring
- + LP gas, carbon monoxide & smoke detectors
- + Fire extinguisher

APPLIANCES

- + 15,000 btu w/heat pump(front), 15,000 btu(rear) & middle(40F ONLY) low profile A/C's
- + Holding tank heat pads
- + Truma continuous flow hot water
- + LP forced air furnace
- + 30" OTR convection microwave oven
- + 2 Door residential refrigerator
- + Electric induction glass cook top
- + Power fan in bathroom w/rain cover
- + Maxxair in galley w/wireless remote control w/rain cover
- + Stackable Washer/dryer
- + Electric fireplace
- + Central vacuum system w/toe kick

OPTIONS

- + Theater seating ilo of sofa
- + Electric Power Cord Reel
- + Matte finish Porcelain tile flooring
- + Trav'ler (Winegard) satellite antennae-Dish Network (US)
- + Trav'ler (Winegard) satellite antennae-Shaw (Canada)

